

GANPATI APARTMENTS

Forest Hill View Apartment

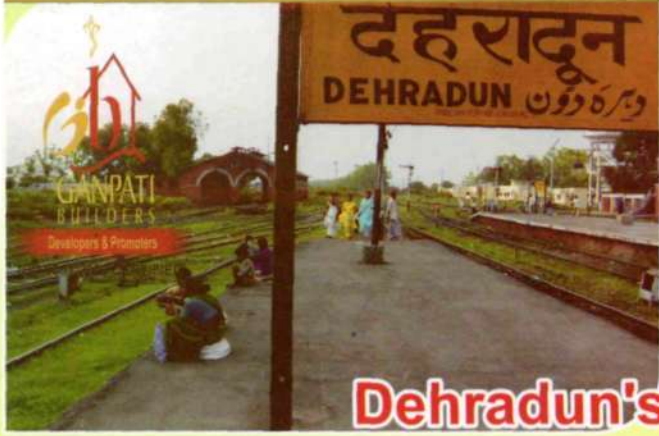

Dehradun's Privileges

Dehradun is interim capital city of state uttarakhand in India. The religious town of Rishikesh, the queen of hills, Mussoorie & a part of "Rajaji National Park" lie in this district. It is surrounded by Himalaya mountains in the north. The cave is a natural picnic spot surrounded by hills where water suddenly disappears from sight & goes underground only to appear a few yards in the form of a stream. The Climate of city is temperate. The city has many beautiful rest houses & good hotels to Provide good accomodation.

WHY DEHRADUN IS BEST OPTION FOR INVESTMENT?

1. 100% excise exemption for 10 years.
2. 100% Income tax exemption for 10 years.
3. Cheap electricity as Uttaranchal has its own hydro power resources.
4. A dedicated land bank being created to provide land for projects across the state.
5. Eco-friendly & high-end tourism.
6. City is well known for educational standards.
7. Wide bandwidth connectivity, STPI earth station. educated & trained man power.

For many years, it has been one of the best known, educational centres in northern India. Dehradun is well linked by rail & road.



Layout Plan



1.20 M. WIDE ROOF PROJ.

Super Area : 1100 sq. ft.

1200 MM WIDE BALCONY

- 1 Drawing
- 2 Bed Room
- 1 Kitchen
- 1 Toilet
- 1 Balcony

BEDROOM
 12'-9" X 11'-6"

DRAWING ROOM
 13'-1.5" X 21'-0"

2825

1520

SHAFT
 9'-3" X 5'-0"

TOILET
 7'-6" X 5'-9"

BEDROOM
 12'-9" X 11'-4"

KITCHEN
 8'-3" X 7'-10.5"

UP

DN

W
1

W
1

4

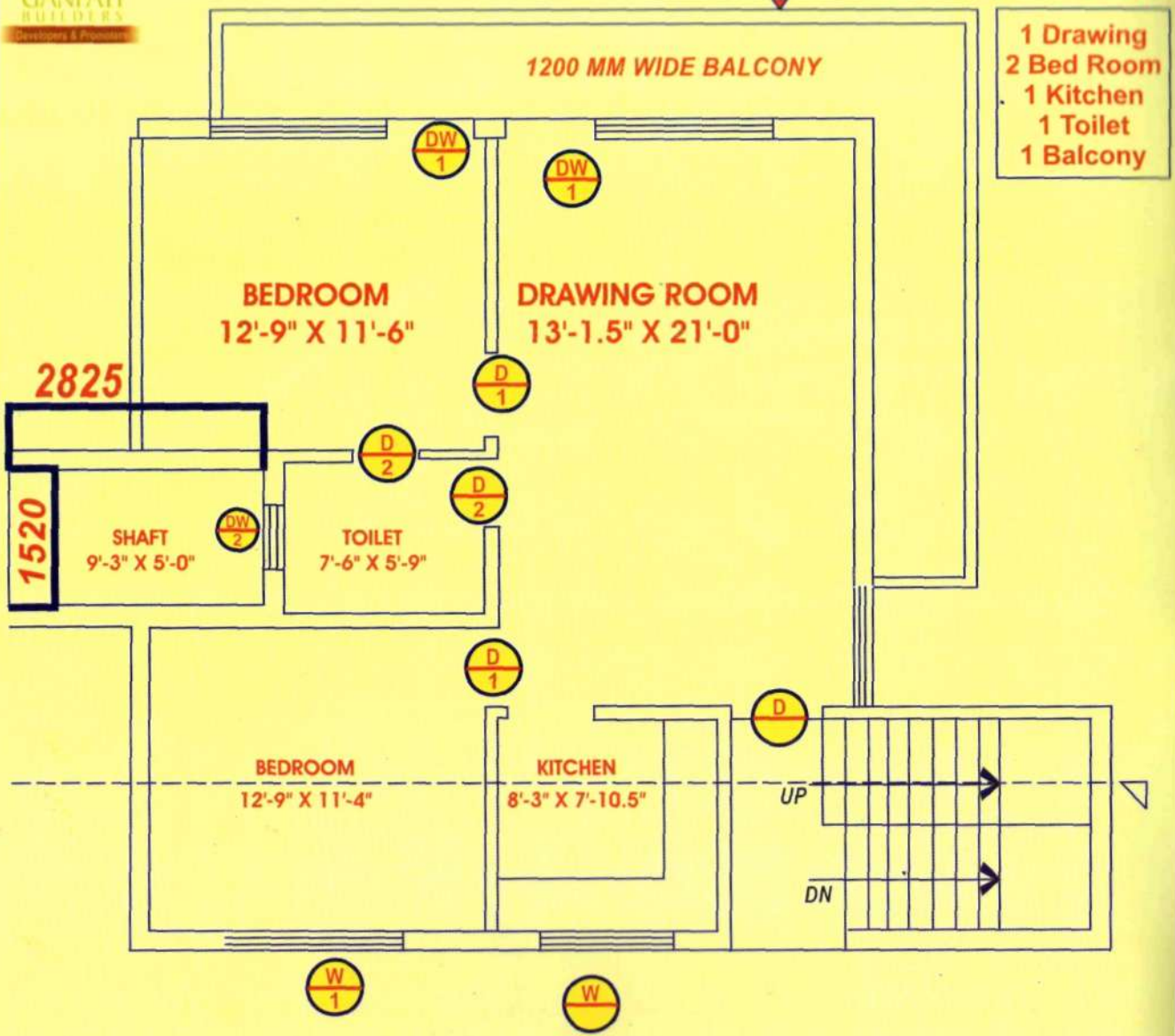

Road Map

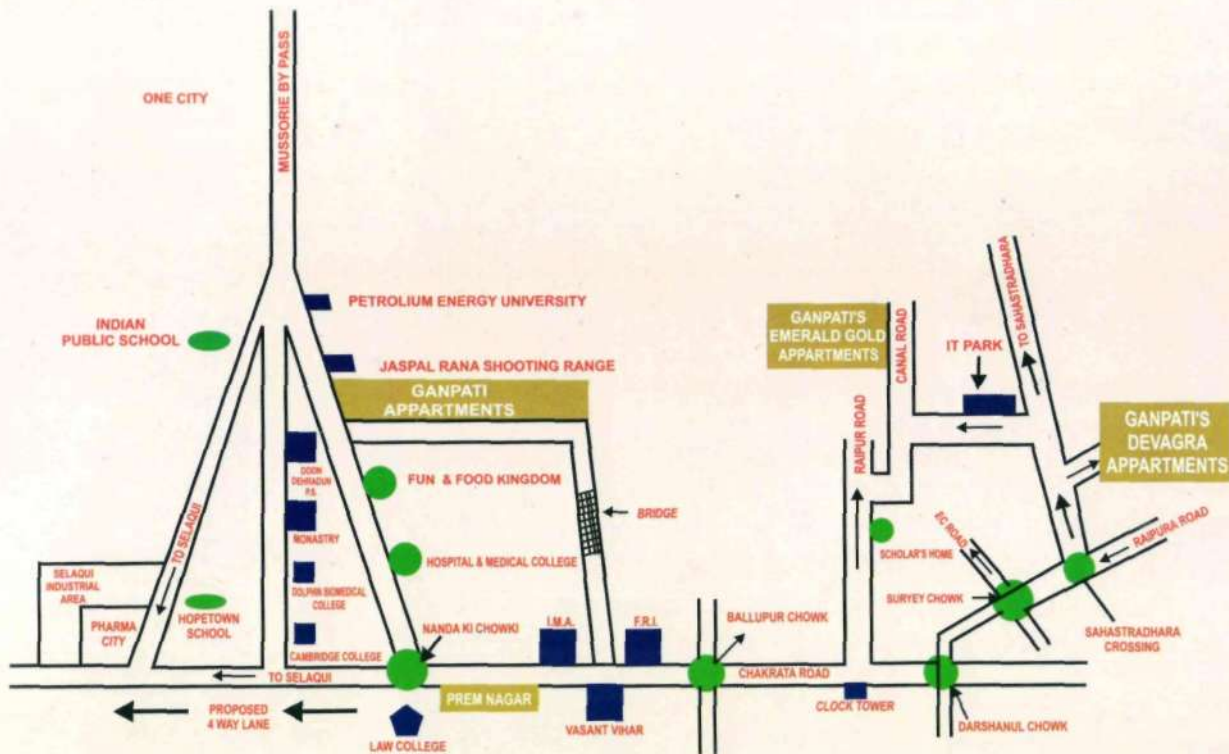

DISTANCE :

- ❖ ON NEW MUSSORIE ROAD
- ❖ 9 KMS FROM I.M.A.
- ❖ 7 KMS NANDA KI CHOWNKI
- ❖ 2 KMS BEFORE PETROLEUM UNIVERSITY



Developers & Promoters

ISO 9001:2000 CERTIFIED

FEATURES

- + Designer Doors.
- + Vitrified Tiles.
- + Fans & Fancy Lights.
- + Bathroom Fitting with Essential accessories.
- + Kitchen Slab with Sink.
- + POP finishing.
- + All Flats are well ventilated.
- + Approved Project.
- + Fountains.
- + Rain water harvesting system.
- + Landscape Garden.
- + Pollution Free Area.
- + Parking.
- + Playing area for Kids.
- + 24 Hour Security.
- + Kids Pool.
- + 24 Hours Water Supply.
- + Attractive Exterior Facade.
- + Earth quake resistant.



SPECIFICATIONS

- Structure** : Earth quake-resistant, R.C.C. frame structure designed by IIT Engg. (as per ISI codes)
- Flooring** : Vitrified tiles, Ceramic tiles in toilet.
- Painting** : Oil bound distemper with pleasing shades on the apartment walls.
- P.O.P.** : Designer P.O.P. in drawing room & bedrooms.
- Exterior** : Permanent Finish
- Kitchen** : Slab are of stone with stainless steel sink and drain board. Glazed tile dado in wall up to 2 ft. over counter.
- Doors & Windows** : Designer flush doors with ISI fitments.
- Bathroom** : Equipped with ISI standard wash basin and WC in varied shades. Chrome plated tap fittings of standard make.
- Electrical** : Electrical (cooper) wiring and switches as per ISI code. Circuits with MCBs of approved make. TV and telephone points in every room



GANPATI
BUILDERS

Developers & Promoters

ISO 9001:2000 CERTIFIED

GANPATI Group has gained a high trajectory growth and accolade across the booming real-estate business. With globalization and the opening up of the Indian economy, opportunities in real-estate are tremendous and vistas almost endless. And it is the real-estate developers like **GANPATI** that are making a lot of this happen. Today, **GANPATI** is among the largest real-estate developers in Delhi and U.P. - involved in four Keys: -Ultra-luxury residential facilities development, shopping Malls-cum-Multiplex, Family Entertainment Centers and Theme Malls. With strong technical expertise base and sturdy financial standing, **GANPATI** is on the threshold of revolutionizing the Indian real-estate industry into a fine art. The secret behind the success of the group is its unquenchable thirst for quality. The turnover of the Company has increased a lot in the past few years.

GANPATI Group has further presented and is in the process of making construction of Luxurious Cottages and Resorts near Vrindavan, Gateway to Lord Krishna and city of Temples, at a distance of about 100 miles from Delhi.

The **GANPATI** Group has started the construction of Residential Colony at Rajpur Road /Sahastra Dhara Road, Dehradun, where about more than 100 Flats are already under construction and some of the flats are completed and possession has already been given.

The Group has successfully launched Group Housing Project named Ganpati Emerald Heights at Shastri Puram, Agra and Ganpati Green at Sikandra, Agra. The Emerald Heights and Air Conditioned Ganpati Green are a Multi-storey Group Housing Projects, offering Two/Three/Four Bedroom Flats with Five Star facilities. The **GANPATI** group has successfully also launched Ganpati Heritage Fatehabad Road, Opposite J.P. hotel, Agra and Ganpati Executive Floors at Sikandra, Agra with 7 star facilities. The main aim of the project is to provide better living to the people in the Temperature city of Agra at affordable price.

The **GANPATI** Group has completed various Residential Projects at Kaushambi.

The turnover of Ganpati Group is running in crores of rupees. **GANPATI** Group wishes to make real-estate a fine art, each project in it is an individual piece of sculpture where its satisfies each client individual criteria and built a piece of art for which every one remembers the Group.

The Ganpati Group is a fast growing real-estate developers and is coming up with lot of more projects in near future.

Projects In Hand :-

1. Flats/ Apartments At Rajender Nagar/ Kaushambi

Status : Completed, Actual Photographs



Ganpati Villas
at Kaushambi, Ghaziabad (U.P.)
2/3/4 Bedroom Flats



Ganpati Villas
at Rajender Nagar (U.P.)
2/3/4 Bedrooms Apartments



2. Flats/Apartments At D.L.F Dilshad/ Radhey Shyam Park/ Vaishali/ Vasundra.

Status : Completed, Actual Photographs



Ganpati Villas
at DLF Dilshad (U.P.)
2/3/4 Bedrooms Apartments



Ganpati Villas
at Radhey Shyam Park (U.P.)
2/3/4 Bedrooms Apartments



Ganpati Villas
at Vaishali (U.P.)
2/3/4 Bedrooms Apartments



Developers & Promoters

ISO 9001:2000 CERTIFIED



3. GANPATI'S Emerald Gold At Dehradun (Luxurious Apartments)

Status : Sold, Actual Photograph



4. Ganpati Devagra Heights at sahastradhara Road, Dehradun.

Status : 80% Sold, Construction in full swing.



5. GANPATI'S Iskon City at Siana, Vrindavan.

Plots Are Available Of The Sizes : 105 To 500 Sq. Yards

Status : Loan Facility, Construction on Full Swing,
Registration Open for Customers, Completed, Actual Photograph



6. Ganpati's Emerald Heights Apartments (Shastri Puram, Agra).

Status : Completed, Actual Photograph



7. GANPATI'S Greens Apartments (Sikandra, Agra).

Status : Bank Loan, Construction On Full Swing,
Sold, Actual Photograph



**GANPATI
BUILDERS**

Developers & Promoters

ISO 9001:2000 CERTIFIED

8. GANPATI'S Heritage (Fatehabad Road, Agra).

Status : Loan Available, Construction in Full Swing,
total sold, Actual Photograph



9. GANPATI'S Executive Floors (Sikandra, Agra)

Status : Loan Available, Construction in Full Swing, total sold



10. GANPATI CITY Township at Navi Mumbai

Plot Sizes Available : 180 To 650 Sq. Yards

Status : Loan Available, Booking Open



11. GANPATI City at Shri Khatushyam Ji

(on main Jaipur - Sikar Highway) Township in 49 Bighas

Status : Construction on Final Stage, 80% Sold



12. GANPATI'S Kanaha Apartments At Shree Khatushyam Ji

(Distance : 600 m.t., from Khatu Ji Temple)

Status : Booking Open



gb
GANPATI
BUILDERS
Developers & Promoters
ISO 9001:2000 CERTIFIED



Head Office : 702, New Delhi House, 27, Barakhamba Road, C.P., New Delhi - 110 001

Phone: 011-65123074-75, 65093831-32, 66270081-84, **Mobiles: 9310584848, 9810315575** Telefax: (+91)011-23731023

Dehradun Office : 231, IInd Floor, Raj Plaza, Rajpur Road, Dehradun (Uttanchal) Phone : 0135-6451702, 9997531209

visit us : www.ganpatibuilders.co.in, **E-mail: ganpatibuilders1998@gmail.com** SMS : GB to 56677

All designs, perspective, specification, layouts, plans etc, are indicative and are subject to change, Accessories shown in the brochure, such as furniture, cabinets, electrical, appliances, light fittings, paintings, wall and floor texture, etc. are indicative /decorative and are not part of the sale offered.

Designed & Printed by : Arjun Prints-on-line # 9311991992, 9350880212, 9350481025, 9810062998, 9015248569 • **E-mail : arjunprints@yahoo.in**